

CNC 35 2.0 T

LT15810BL3

Lombardo.

NEW

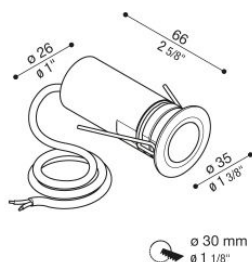

Informazioni tecniche:

Installazione:	Incasso terra, Incasso parete, Incasso soffitto
Materiale Corpo:	Alluminio
Finitura:	PVD nero
Trattamento:	Anodizzazione
Tipo di diffusore:	Vetro trasparente
Inclinazione ottica:	45°
Tipo lampada:	LED
Classe energetica:	G
Temperatura colore:	3000K
CRI:	>90
LB Factor:	L80B20 - 100.000h
Step MacAdam:	3
Rischio fotobiologico:	RG1
Potenza assorbita Watt:	2
Lumen:	150
Real Lumen:	147
Alimentazione:	⊗ esclusa
LED:	24V
Classe di isolamento:	⊠ CL.III
Cavo Alimentazione:	0,50 metri H05RN-F 2x0,75
Grado di protezione:	IP 67
Resistenza alla rottura:	IK 10 20J xx9
Marchi di Conformità:	CE UK
Caratteristiche aggiuntive:	↓ 500 ^{KG} _{MAX} Temp. max on diffuser 65°C

Versione Honeycomb non disponibile con ottica D.

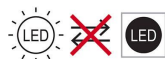

CNC 35 2.0 T

LT15810BL3

Lombardo.

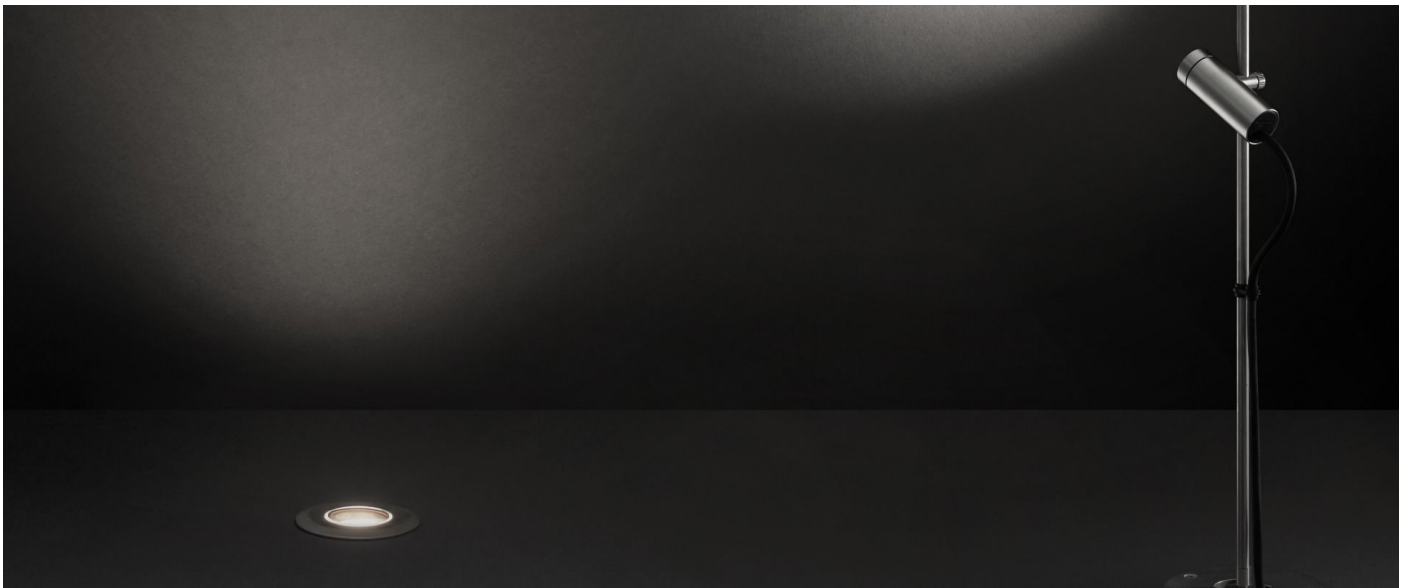

Immagini di montaggio:

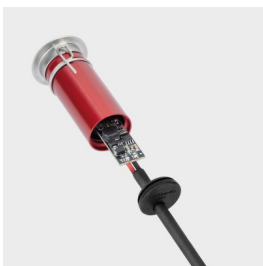

Simulazioni illuminotecniche:

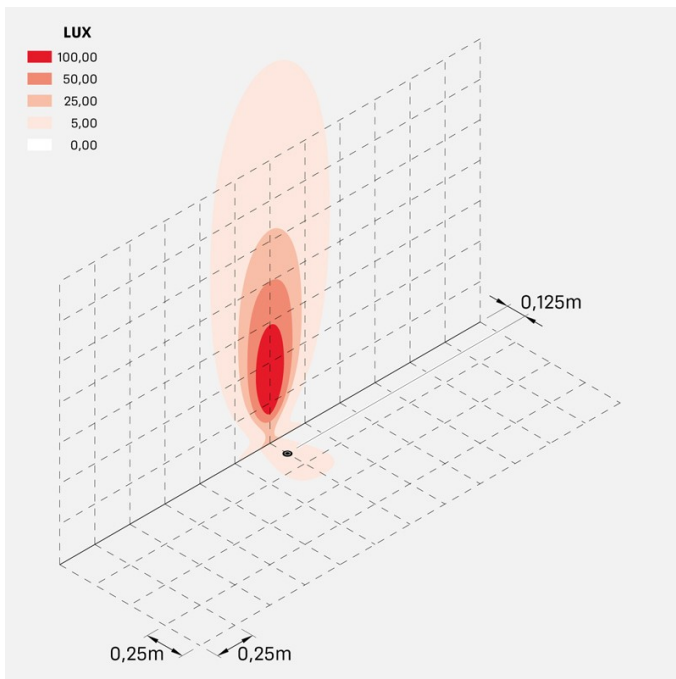

cnc_35t_20_optic_S

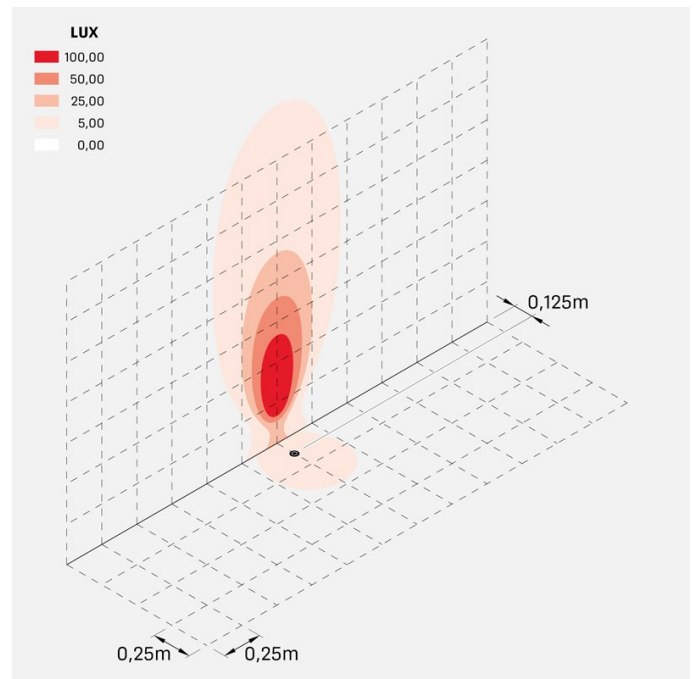

cnc_35t_20_optic_M

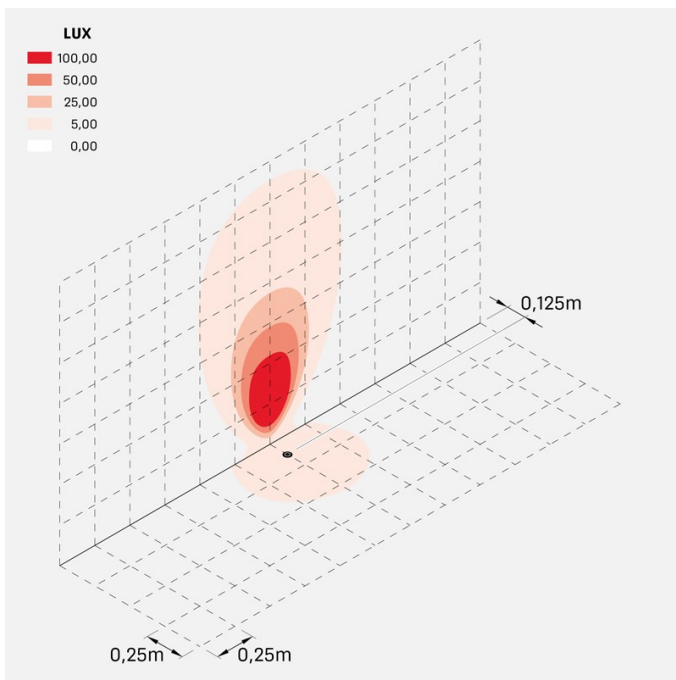

cnc_35t_20_optic_L

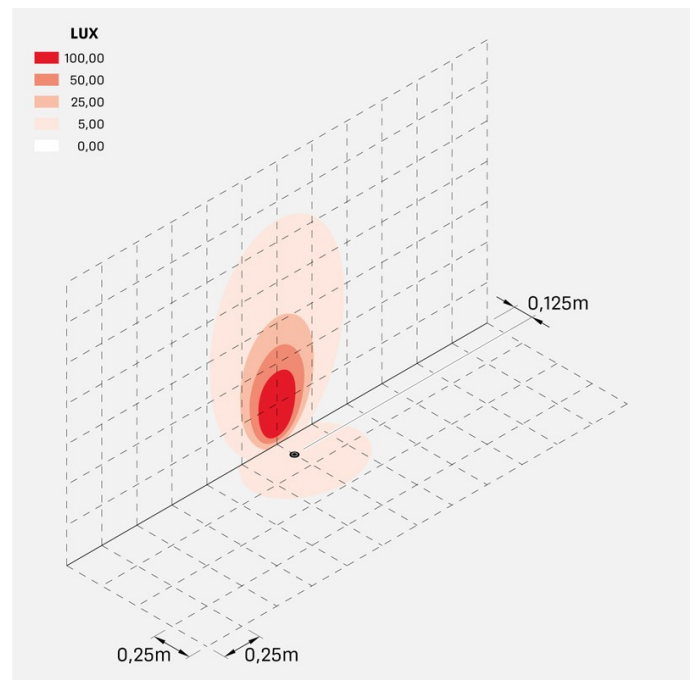

cnc_35t_20_optic_D