

inclusi
included
einbegriffen
compris
incluido
incluido

5b

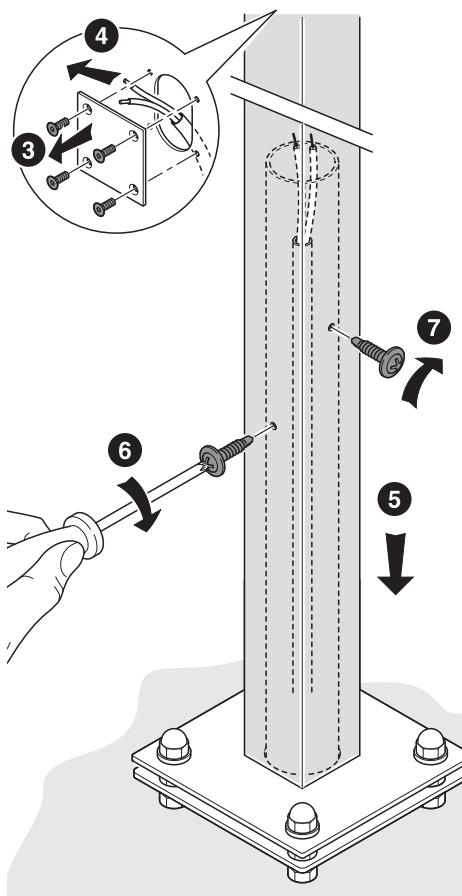
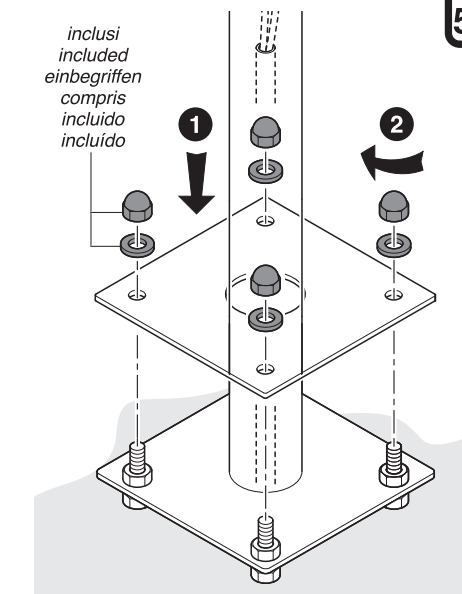

1 Eseguire il cablaggio elettrico seguendo le operazioni descritte al punto 3 - FIFLAG00
Carry out electrical wiring as described in point 3 - FIFLAG00
Führen Sie die elektrische Verdrahtung wie in Punkt 3 - FIFLAG00 beschrieben durch.
Réaliser le câblage électrique en suivant les opérations décrites au point 3 - FIFLAG00
Realizar el cableado eléctrico siguiendo las operaciones descritas en el punto 3 - FIFLAG00
Efectuar a cablagem eléctrica seguindo as operações descritas no ponto 3 - FIFLAG00

6

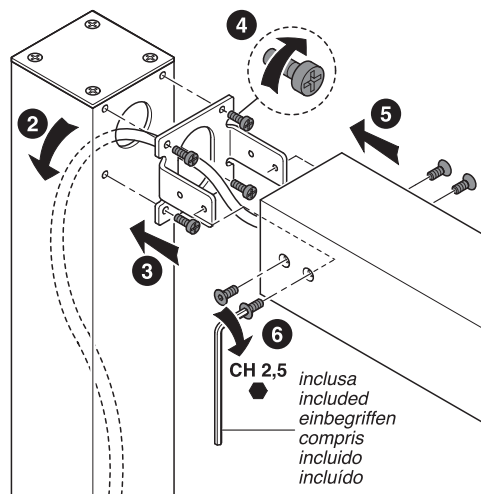

CH 2,5
inclusa
included
einbegriffen
compris
incluido
incluido

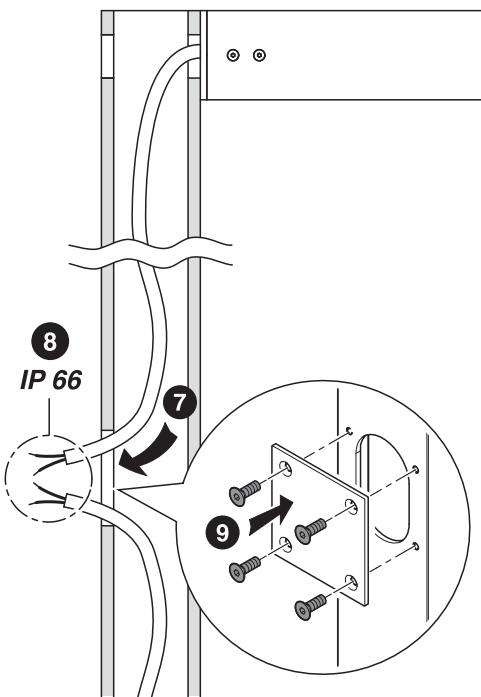

7

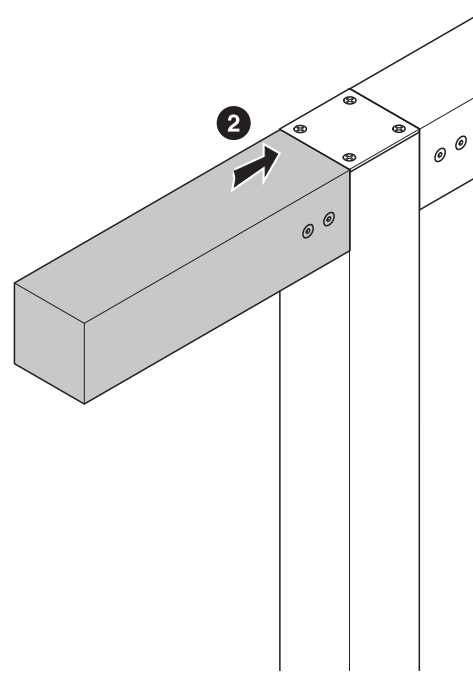
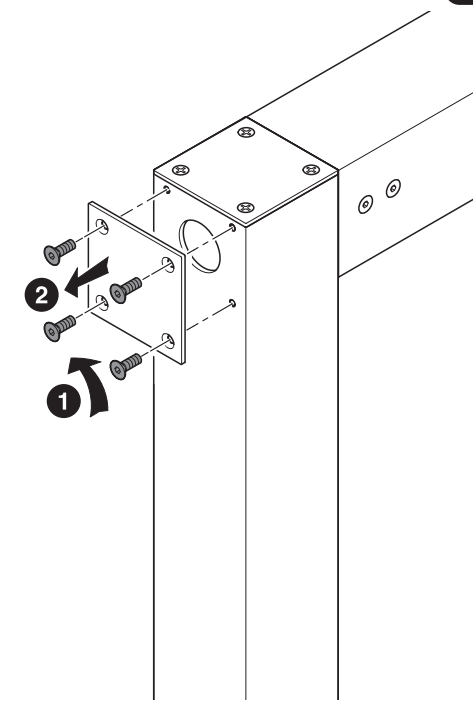

Cod. FIFLAG05 Rev. C 02/2023 gfi/studio

LOMBARDO



PALO FLAG 330

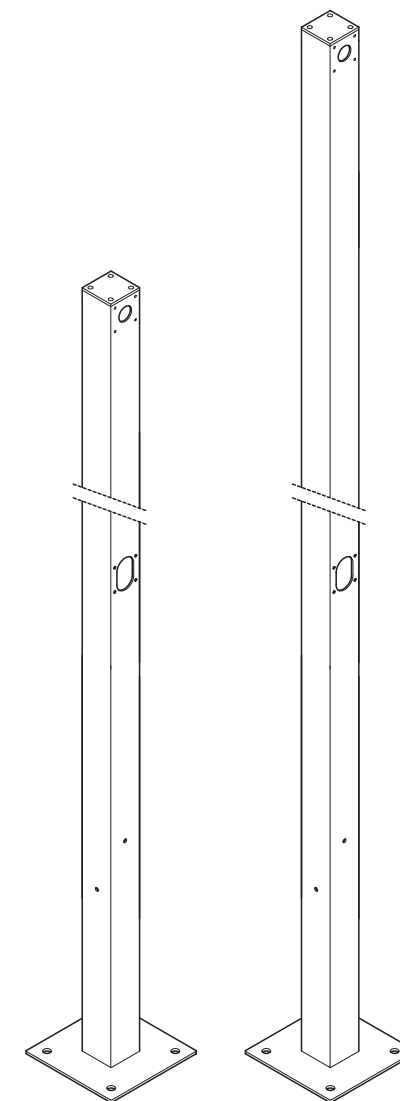

H. 3000

H. 4000

LOMBARDO S.r.l.

Via Pizzigoni, 3 - 24060 VILLONGO (Bergamo) Italia

Tel. +39 035 939411 - Fax +39 035 939496

www.lombardo.it e-mail: info@lombardo.it

